

Step #1: Set Up the Printer

- ✓ Unpack the TS240/TTP printer.

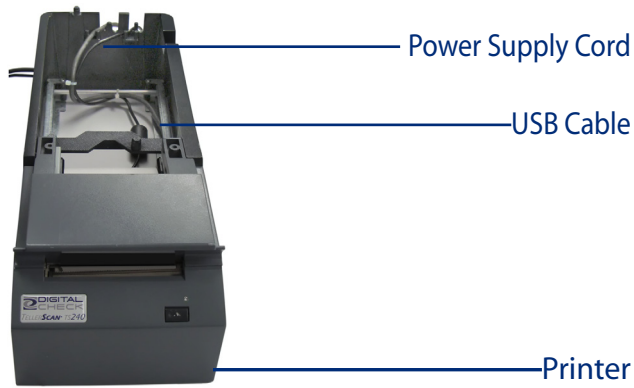

- ✓ The USB Cable and Power Supply Cord are pre-attached to the Printer. Plug the Power Supply into an electrical outlet and connect the USB Cable to the PC.
- ✓ Verify that the cables are routed through the strain reliefs as shown.

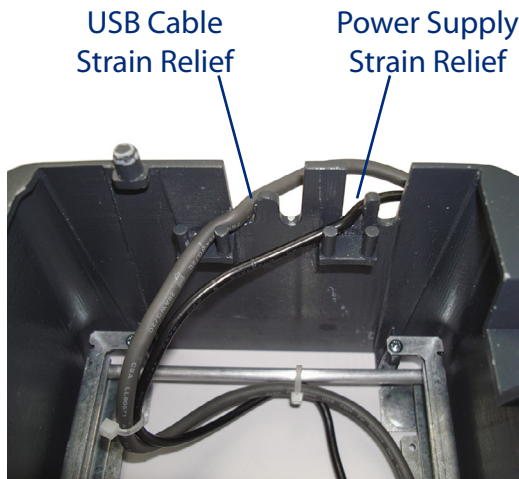

Step #2: Position the TS240 Scanner

- ✓ Set the TS240 check scanner on the printer as shown. The scanner simply sits on top of the printer platform and after it has been aligned, it will remain secured on the platform.



- ✓ Next, pull out the printer tray from the platform. This is the procedure used to install or replace the thermal paper rolls. Pull out the tray far enough to allow the lid to be lifted up provide access to the thermal paper roll housing.



Step #3: Loading the Paper Rolls

- ✓ Lift up on printer cover to access the internal paper roll housing. Place the roll into the printer and unroll the paper in the 'underhand' method as shown.

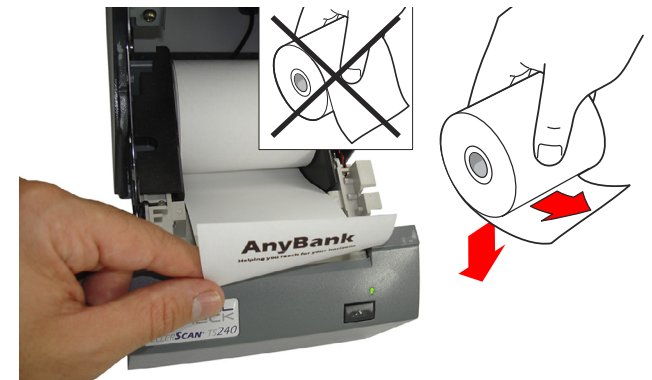

Step #4: Run the Diagnostic Test

- ✓ Open and begin to close the printer lid. Hold down the Paper Feed Button while closing the lid completely.

The printer will start to automatically print a diagnostics receipt. This is to confirm that the printer is working properly.



Paper Feed

Sample Diagnostics Receipt

```

xxx A799 - Diagnostics Form xxx
ReceiptWare Enabled
Model number      : A799-1234-5678
Serial number     : K010101010
Boot Firmware
Revision          : V1.05
CRC              : A396
P/N              : 189-7940193A
Flash Firmware
Revision         : V1.05
CRC             : 0405
P/N             : 189-7940192B
H/W parameters
Flash Memory Size : 4 Mbytes
Flash Logo/Fonts  : 1472 kbytes
Flash User Storage: 64 kbytes
Flash Mem Int Fonts: 1472 kbytes
Flash Journal Size: 64 kbytes
SRAM Size         : 256 kbytes
Head setting
Motor ID          : 1
Paper Type setting: Type 0, Monochrome
Color Density Adj: 1/8
Print Density, Mono: 100 %
Max Speed         : 250 mm/sec
Paper Width       : 80 mm
Max Power         : 35 W
Knife            : Enabled
Partial Out       : 140 steps
Paper Low Sensor  : Enabled
No Paper Low Extension
Comm. Interface
RX Buffer Size    : 4096
Interface type   : RS232/USB
Parameters
Baud Rate        : 115200
Data Bits        : 8
Stop Bit         : 1
Parity           : NONE
Flow Control     : DTR/DSR
Reception Errors : Ignore
USB Driver Type  : Native
USB Packet w/Error: Reject
Resident Code Pages : 437, 850, 852, 858
                  : 860, 863, 865, 866
                  : 1252, 862, 737, 857
Logo(s) defined  : NO
User Char(s) defined: NO
Journal Unused   : 64 kbytes

To enter Printer Config Menu :
1) Flip DIP switch #1 down
2) Reset the printer, while holding
the Paper Feed button down
    
```

Step #5: Secure the Printer Tray

- ✓ Slide the printer tray securely back into place.



Your printer is now ready to use.

Please contact your banking software provider for the necessary software or deposit application to use your new printer.

Troubleshooting

Condition:

Printer does not function when connected.

Possible causes:

- **LED near the Paper Feed button is not illuminated**
 - Check the power source and cables going into the printer unit
- **Green LED, fast steady flashing**
 - Check for paper out condition
 - Receipt cover open or not fully closed
- **Confirm that the USB cable is connected to the PC and that the printer is showing up in 'Device Manager'**
 - Check where the USB cable plugs into the printer mechanism
 - Try a different USB port on the PC
 - Try a different USB cable
- **Receipt does not come out all of the way**
 - Paper might be jammed
 - Press the Paper Feed button to test if the paper is feeding correctly